

PA AUTO SHOW 2024
 January 25-28, 2024
 EXPO HALL
 PA FARM SHOW COMPLEX
 HARRISBURG, PA

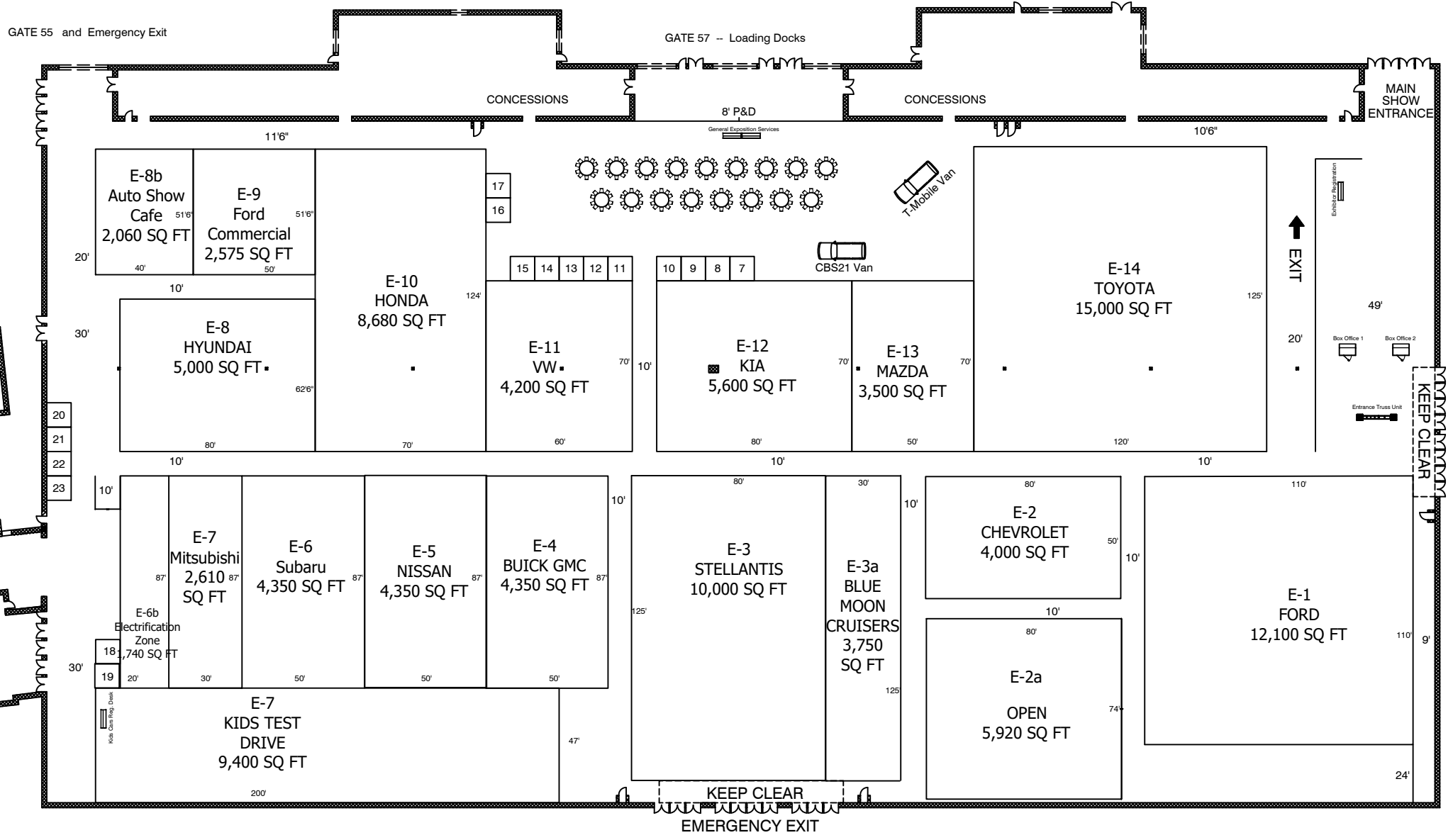

Produced By:
General Exposition Services
THE TRADE SHOW SERVICE CONTRACTORS
www.generalexposition.com
 610-495-8866 Phone
 11.27.23 C. McKenrick

Please note: Every effort has been made to ensure the accuracy of all the information contained on the floorplan. However, no warranties are made with respect to this floorplan. If the location of building columns, utilities or other architectural components of the building is a factor in the construction or usage of an exhibit. It is the sole responsibility of the exhibitor to physically inspect the facility to verify all dimensions and locations.

NORTHWEST HALL

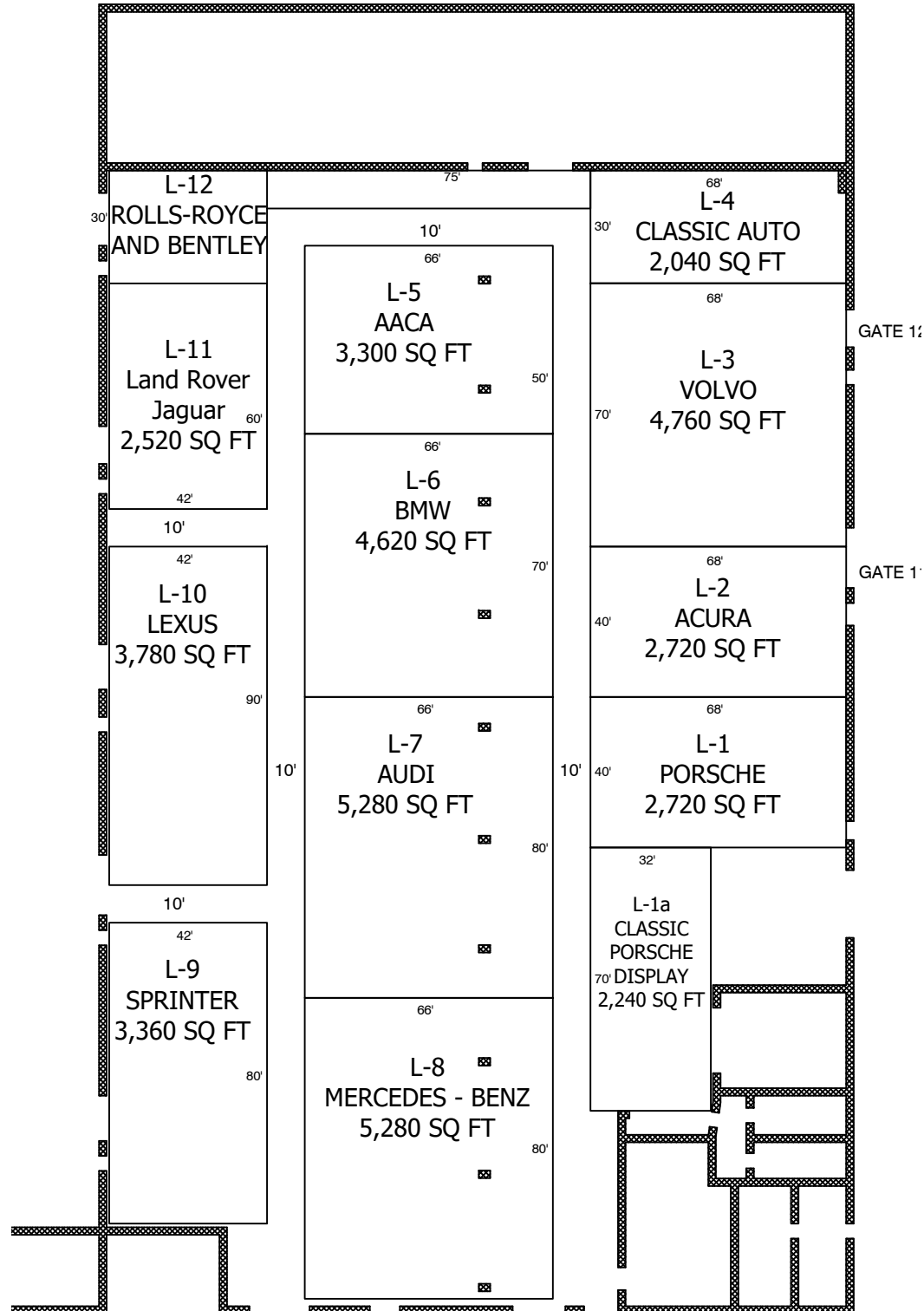

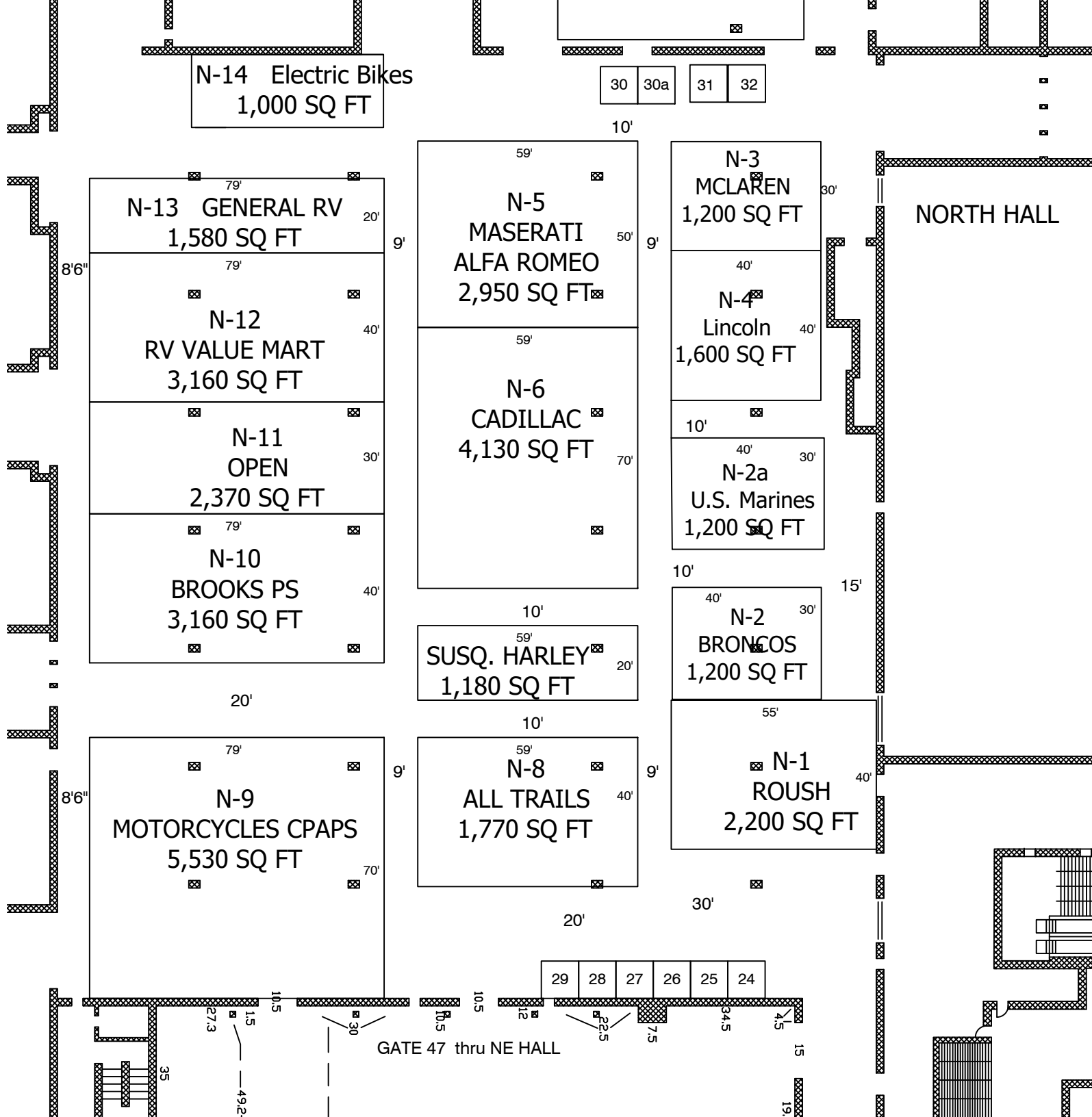

N-14 Electric Bikes
1,000 SQ FT

30 30a 31 32

N-13 GENERAL RV
1,580 SQ FT

N-5 MASERATI
ALFA ROMEO
2,950 SQ FT

N-3 MCLAREN
1,200 SQ FT

NORTH HALL

N-12 RV VALUE MART
3,160 SQ FT

N-6 CADILLAC
4,130 SQ FT

N-4 Lincoln
1,600 SQ FT

N-11 OPEN
2,370 SQ FT

N-2a U.S. Marines
1,200 SQ FT

N-10 BROOKS PS
3,160 SQ FT

SUSQ. HARLEY
1,180 SQ FT

N-2 BRONCOS
1,200 SQ FT

N-9 MOTORCYCLES CPAPS
5,530 SQ FT

N-8 ALL TRAILS
1,770 SQ FT

N-1 ROUSH
2,200 SQ FT

29 28 27 26 25 24

GATE 47 thru NE HALL